

Stone and sorting grab SG03-SG33

engcon®

For all excavators in the 1,5-33 tonne weight classes

Engcon's stone & sieve grabs in the SG series are suitable for everything from sorting to light demolition works where a powerful grab is needed. Used in combination with Engcon's tiltrotators, the grabs provide the access you need, and they also come with EC-Oil automatic oil connection system as standard equipment.*



The advantages of SG grabs

- » The EC-Oil automatic quick connection system connects the hydraulics without the operator having to leave the cab.
- » The grab's claws are fitted with reversible wear bars
- » A load valve and pressure accumulator maintain gripping force for extended periods and for better handling
- » Complies with European safety standards
- » Expander bushings in major joints
- » Bolt-on bracket/attachment point makes switching brackets easy.

Accessories:

- » Tooth kit for better grip
- » Closed sides to convert the grab into a grab bucket

*Applies to grabs with S45-S80 top brackets



With teeth
(accessory)



With closed sides
(accessory)

NEW! The EC-Oil automatic quick hitch system is a free standard on all engcon's hydraulic tools with S45-S80 attachment

Specifications

Model	SG03	SG06	SG12	SG19	SG26	SG33
Grab width A: (max. mm)	750	1,110	1,660	1,790	1,990	2,575
Grab width A: (min. mm)	0	0	0	0	0	0
Cutting width B: (mm)	400	505	715	860	860	1,170
Jaw length C: (mm)	490	460	680	790	870	1,180
Height D: (mm)	550	580	790	960	1,070	1,360
Gripping force: (kN)	5.7	8.7	15	19	25	45
Max hydraulic pressure: (MPa)	22	22	22	22	22	22
Weight: (kg)*	108	180	425	646	755	-
Volume, with side plates: (l)	42	83	220	336	420	930
Grab area: (m ²)	0.12	0.17	0.34	0.42	0.52	0.85
Recommended machine weight: (t)	1.5-3	3-6	6-12	12-19	18-26	24-33
Recommended tiltrotator:	EC02	EC204 EC206	EC206 EC209 EC214	EC214 EC219	EC219 EC226	EC226 EC233

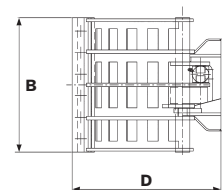
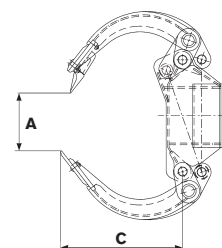

*Depending on attachment

TOOL SYSTEMS FOR INCREASED PROFITABILITY

engcon Australia 62 Power Street, St Marys, NSW 2760
Phone 02 8328 0690 | E-mail australia@engcon.com | Web engcon.com